

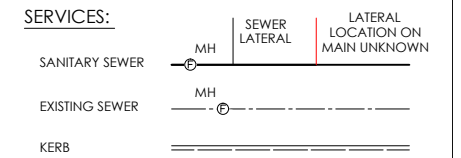

AMENDMENTS:		
AMENDMENT	DATE	DESCRIPTION

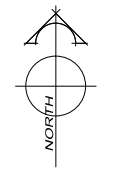

- NOTES:**
1. LOCATION OF LATERALS PROVIDED BY FULTON HOGAN LIMITED.
  2. ALL LATERALS ARE LAYED AT 1:60 MINIMUM GRADE.
  3. ALL LATERALS ARE 100mm Ø UPVC.
  4. LEVELS IN TERMS OF MEAN SEA LEVEL LYTELTON DATUM 1937.
- ORIGIN OF LEVELS :SS11A SO 797 RL=9.42.

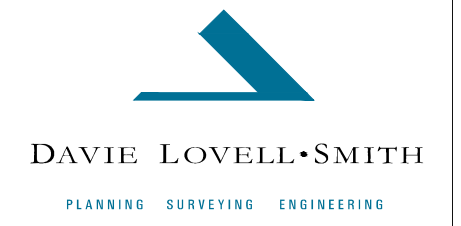

79 Cambridge Terrace P O Box 679 Christchurch 8140, New Zealand  
 Telephone: 03 379-0793 Fax: 03 379-5664 E-mail: office@dls.co.nz

JOB TITLE: **Fulton Hogan Ltd.  
 Rosemerryn - Lincoln  
 Stages 3 & 3A**

SHEET TITLE: **Sewer Asbuilt**

DRAWING STATUS: **Asbuilt**

SCALE: 1:500@A1 DATE: April 2012  
 1:1000@A3

CAD FILE: J:\17975\ASBUILT\S17975.A801\_SDC.dwg REVISION:  
 DRAWING No: SHEET No:  
**S.17975.AB.SS01.0** **RO**



AMENDMENT	DATE	DESCRIPTION

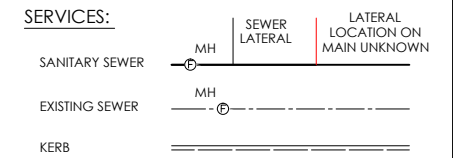
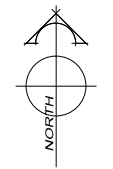

- NOTES:**
1. LOCATION OF LATERALS PROVIDED BY FULTON HOGAN LIMITED.
  2. ALL LATERALS ARE LAYED AT 1:60 MINIMUM GRADE.
  3. ALL LATERALS ARE 100mm Ø UPVC.
  4. LEVELS IN TERMS OF MEAN SEA LEVEL LYTELTON DATUM 1937.
- ORIGIN OF LEVELS :SS1 1A SO 797 RL=9.42.

**DAVIE LOVELL-SMITH**  
PLANNING SURVEYING ENGINEERING

79 Cambridge Terrace P O Box 679 Christchurch 8140, New Zealand  
Telephone: 03 379-0793 Fax: 03 379-5664 E-mail: office@dls.co.nz

**JOB TITLE:**  
Fulton Hogan Ltd.  
Rosemerryn - Lincoln  
Stages 3 & 3A

**SHEET TITLE:**  
Sewer Asbuilt

**DRAWING STATUS:**  
Asbuilt

**SCALE:** 1:500@A1  
1:1000@A3

**DATE:** April 2012

**CAD FILE:** J:\17975\ASBUILTS\17975.AB01.SDC.dwg

**DRAWING No.:** S.17975.AB.SS01.1

**SHEET No.:** RO

**REVISION:**



AMENDMENTS:		
AMENDMENT	DATE	DESCRIPTION

NOTES:

SERVICES:

STORMWATER MH

EXISTING STORMWATER MH

KERB

- NOTES:
1. LOCATION OF LATERALS PROVIDED BY FULTON HOGAN LIMITED.
  2. ALL CONNECTIONS TO KERB ADAPTORS ARE EVIDENT ON SITE.
  3. ALL STORMWATER LATERALS ARE Ø100mm uPVC UNLESS SHOWN OTHERWISE.
  4. LEVELS IN TERMS OF MEAN SEA LEVEL LYTELTON DATUM 1937.

ORIGIN OF LEVELS :SS1 1A SO 797 RL=9.42.

**DAVIE LOVELL SMITH**

PLANNING SURVEYING ENGINEERING

79 Cambridge Terrace P O Box 679 Christchurch 8140, New Zealand  
 Telephone: 03 379-0793 Fax: 03 379-5664 E-mail: office@dls.co.nz

JOB TITLE:

**Fulton Hogan Ltd.  
Rosemerryn - Lincoln  
Stages 3 & 3A**

SHEET TITLE:

**Stormwater Asbuilt**

DRAWING STATUS:

**Asbuilt**

SCALE: 1:500@A1 DATE: April 2012  
 1:1000@A3

CAD FILE: J:\17975\ASBUILTS\17975.AB01\_SDC.dwg REVISION:

DRAWING No: S.17975.AB.SW01.0 SHEET No: RO



AMENDMENTS:		
AMENDMENT	DATE	DESCRIPTION

NOTES:

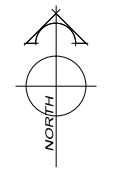

SERVICES:

STORMWATER ——— MH ———

EXISTING STORMWATER ——— MH ———

KERB ———

- NOTES:
1. LOCATION OF LATERALS PROVIDED BY FULTON HOGAN LIMITED.
  2. ALL CONNECTIONS TO KERB ADAPTORS ARE EVIDENT ON SITE.
  3. ALL STORMWATER LATERALS ARE Ø100mm uPVC UNLESS SHOWN OTHERWISE.
  4. LEVELS IN TERMS OF MEAN SEA LEVEL LYTELTON DATUM 1937.
- ORIGIN OF LEVELS :SS1A SO 797 RL=9.42.

**DAVIE LOVELL-SMITH**  
PLANNING SURVEYING ENGINEERING

79 Cambridge Terrace P O Box 679 Christchurch 8140, New Zealand  
Telephone: 03 379-0793 Fax: 03 379-5664 E-mail: office@dls.co.nz

JOB TITLE:  
**Fulton Hogan Ltd.  
Rosemerryn - Lincoln  
Stages 3 & 3A**

SHEET TITLE:  
**Stormwater Asbuilt**

DRAWING STATUS:  
**Asbuilt**

SCALE: 1:500@A1 DATE: April 2012  
1:1000@A3

CAD FILE: J:\17975\ASBUILTS\17975.AB01\_SDC.dwg REVISION:  
DRAWING No: SHEET No:  
**S.17975.AB.SW01.1** **RO**



AMENDMENTS:		
AMENDMENT	DATE	DESCRIPTION

NOTES:

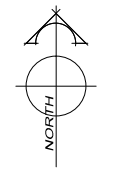

- SERVICES:
- STORMWATER  MH
  - EXISTING STORMWATER  MH
  - KERB

- NOTES:
1. LOCATION OF LATERALS PROVIDED BY FULTON HOGAN LIMITED.
  2. ALL CONNECTIONS TO KERB ADAPTORS ARE EVIDENT ON SITE.
  3. ALL STORMWATER LATERALS ARE Ø100mm uPVC UNLESS SHOWN OTHERWISE.
  4. LEVELS IN TERMS OF MEAN SEA LEVEL LYTELTON DATUM 1937.
- ORIGIN OF LEVELS :SS1 1A SO 797 RL=9.42.



**DAVIE LOVELL-SMITH**  
 PLANNING SURVEYING ENGINEERING

79 Cambridge Terrace P O Box 679 Christchurch 8140, New Zealand  
 Telephone: 03 379-0793 Fax: 03 379-5664 E-mail: office@dls.co.nz

JOB TITLE:  
**Fulton Hogan Ltd.  
 Rosemerryn - Lincoln  
 Stages 3 & 3A**

SHEET TITLE:  
**Stormwater Asbuilt**

DRAWING STATUS:  
**Asbuilt**

SCALE: 1:500@A1 DATE: April 2012  
 1:1000@A3

CAD FILE: J:\17975\ASBUILT\S17975.AB01\_SDC.dwg REVISION:  
 DRAWING No: SHEET No:  
**S.17975.AB.SW01.2** **RO**



AMENDMENTS:		
AMENDMENT	DATE	DESCRIPTION

NOTES:

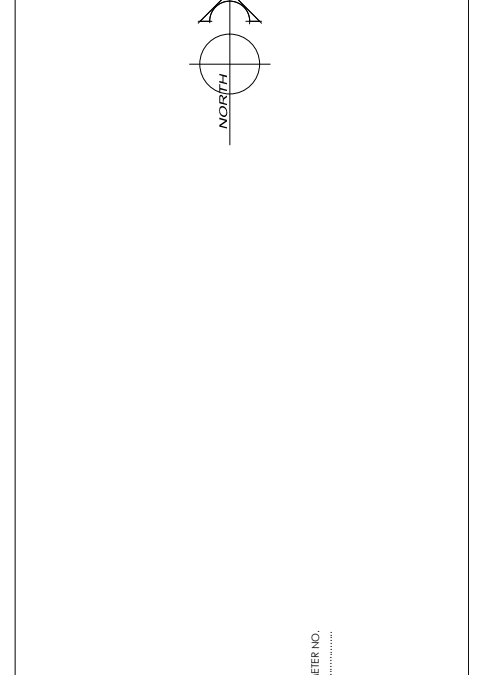
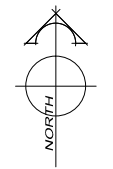

- NOTES:
- ALL SUBMAINS ARE Ø63mm (OD) PE BLUELINE PN12.5 WITH ASSOCIATED FITTINGS.
  - ALL HOUSE CONNECTIONS ARE 25mm POLY AND INCLUDE GATE VALVE, TOBY BOX, TAPPING BAND & FERRULE.
  - ALL MAINS ARE CLASS D uPVC OR SIMILAR APPROVED.
  - ALL WATER LATERALS ARE Ø25mm PE 'BLUELINE' PN12.5 WITH ASSOCIATED FITTINGS.

**DAVIE LOVELL-SMITH**  
PLANNING SURVEYING ENGINEERING

79 Cambridge Terrace P O Box 679 Christchurch 8140, New Zealand  
Telephone: 03 379-0793 Fax: 03 379-5664 E-mail: office@dls.co.nz

JOB TITLE:  
**Fulton Hogan Ltd.  
Rosemerryn - Lincoln  
Stages 3 & 3A**

SHEET TITLE:  
**Water Asbuilt**

DRAWING STATUS:  
**Asbuilt**

SCALE: 1:500@A1 DATE: April 2012  
1:1000@A3

CAD FILE: J:\17975\ASBUILTS\17975.AB01\_SDC.dwg REVISION:  
DRAWING No: SHEET No: 1 of 1  
**S.17975.AB.W01.0** **RO**

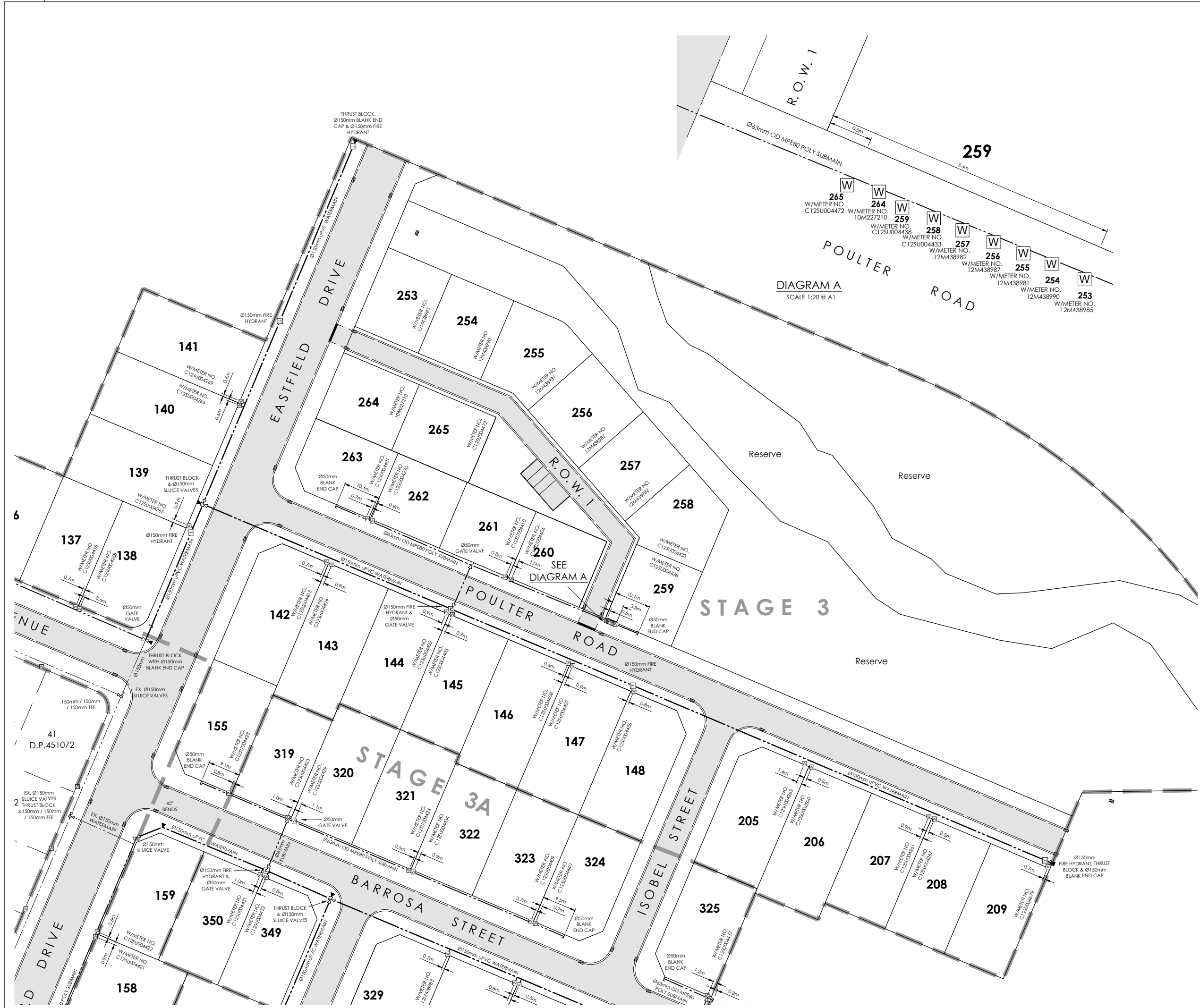

AMENDMENT	DATE	DESCRIPTION

NOTES:

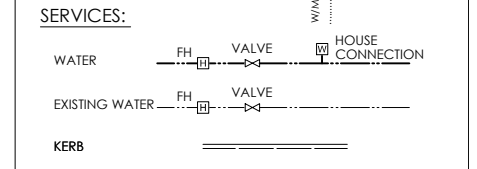
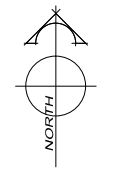

- NOTES:**
- ALL SUBMAINS ARE Ø63mm (OD) PE BLUELINE PN12.5 WITH ASSOCIATED FITTINGS.
  - ALL HOUSE CONNECTIONS ARE 25mm POLY AND INCLUDE GATE VALVE, TOBY BOX, TAPPING BAND & FERRULE.
  - ALL MAINS ARE CLASS D uPVC OR SIMILAR APPROVED.
  - ALL WATER LATERALS ARE Ø25mm PE 'BLUELINE' PN12.5 WITH ASSOCIATED FITTINGS.



**DAVIE LOVELL-SMITH**  
PLANNING SURVEYING ENGINEERING

79 Cambridge Terrace P O Box 679 Christchurch 8140, New Zealand  
Telephone: 03 379-0793 Fax: 03 379-5664 E-mail: office@dls.co.nz

**JOB TITLE:**  
Fulton Hogan Ltd.  
Rosemerryn - Lincoln  
Stages 3 & 3A

**SHEET TITLE:**  
Water Asbuilt

**DRAWING STATUS:**  
Asbuilt

**SCALE:** 1:500@A1  
1:1000@A3

**DATE:** April 2012

**CAD FILE:** J:\17975\ASBUILTS\17975.AB01.SDC.dwg

**DRAWING No:** S.17975.AB.W01.1

**SHEET No:** 1 of 1

**REVISION:** RO